

618400

618500

135500

135500

135400

135400

135300

135300

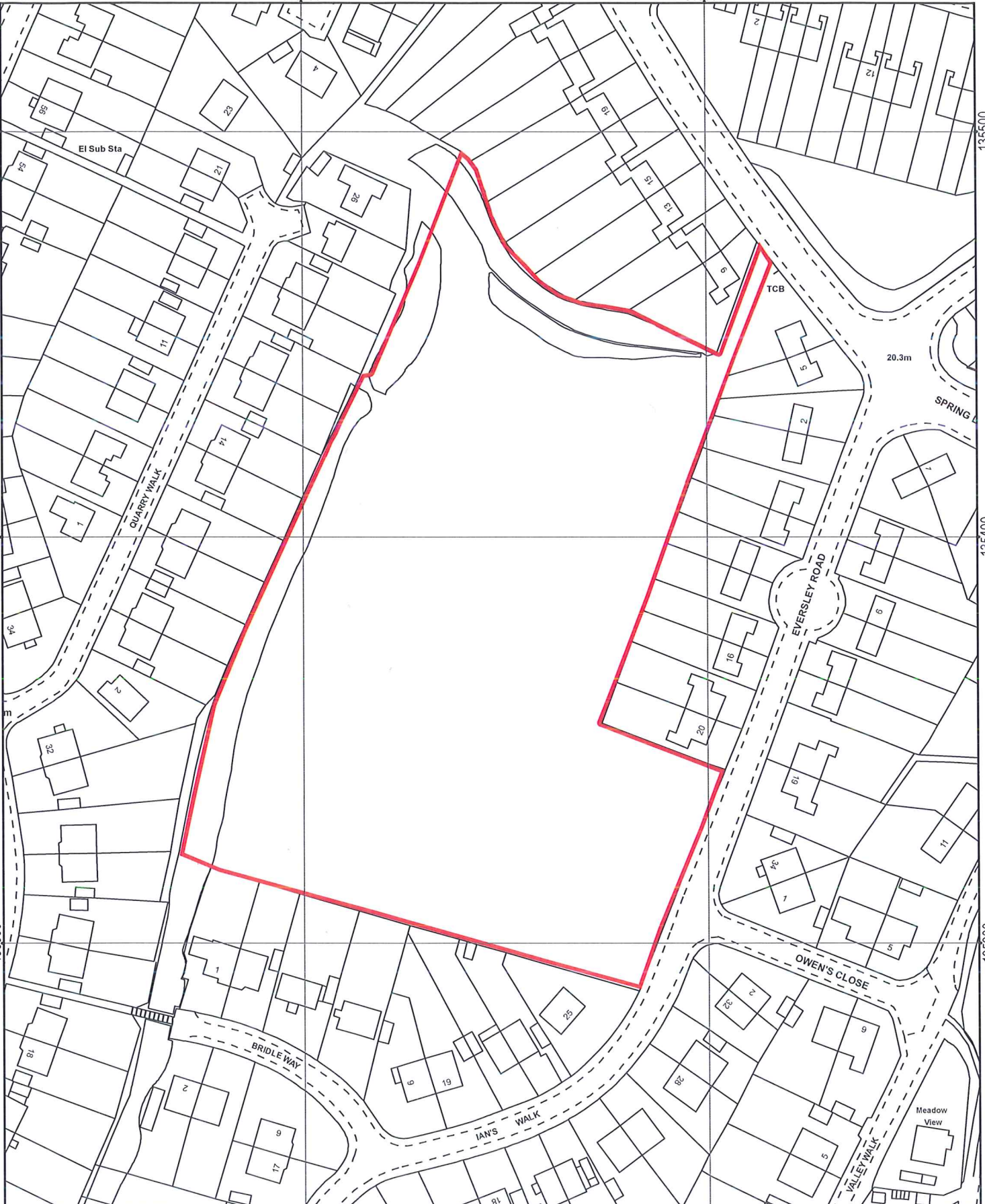

N



Based upon the Ordnance Survey map with the permission of the Controller of Her Majesty's Stationery Office.
 (C) Crown Copyright & database right 2011.
 Ordnance Survey 100019238.
 Additional information copyright Kent County Council

618400

RECTORY FIELD
 EVERSLEY ROAD
 HYTHE

UPRN 54600100

618500

MasterMap



PROPERTY AND
 INFRASTRUCTURE SUPPORT
 County Hall, Maidstone
 Kent ME14 1XQ
 Tel:08458 247247

Drawn By

KP

Date

AUG 2012



1:1250

@ A4

Drawing No.

TR1835/9G